

**NOTES:**

1. REINFORCING STEEL GRADE 60 DEFORMED BARS.
2. CONCRETE: 4-6% ENTRAINED AIR, 4" MAX SLUMP, 3000 psi MIN..

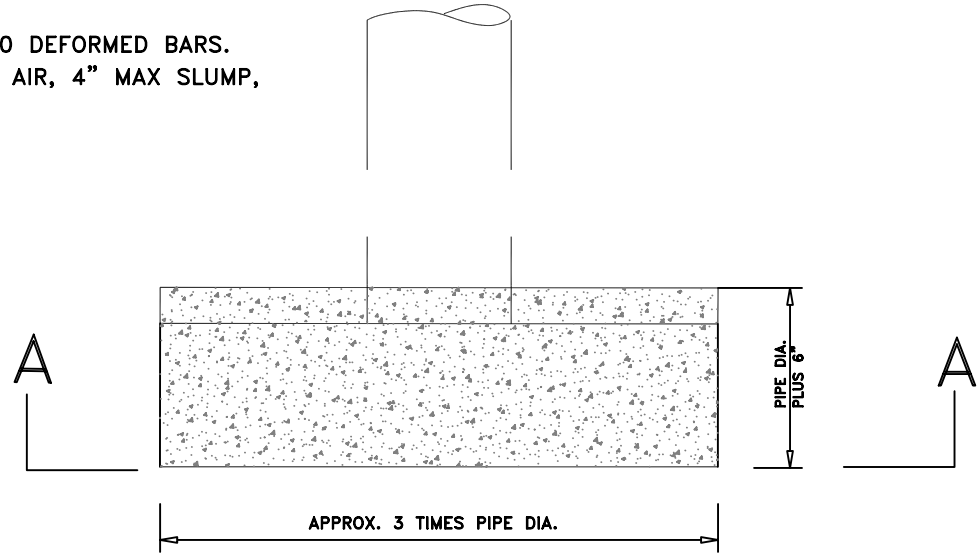

Plan

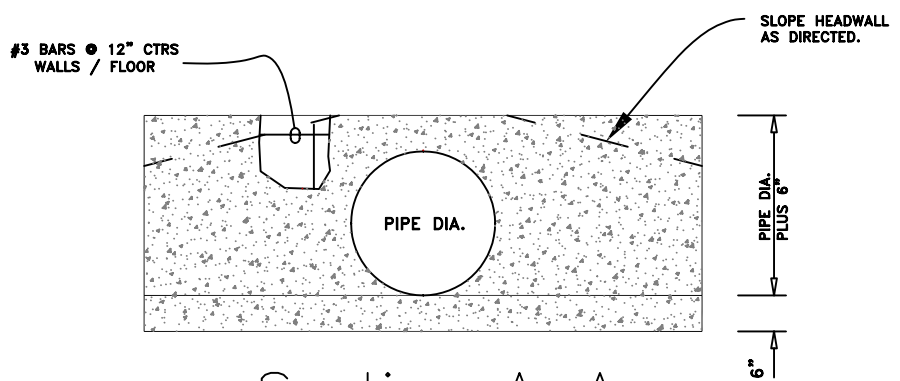

Section A-A

STANDARD HEADWALL

JACKSON COUNTY ROADS

DALE W. PETRASEK, P.E.  
COUNTY ENGINEER

Date	By	Revision
1/2002	TMJ	
07/2003	TCM	

TYPICAL HEADWALL

I:\Engineering\Library\County\English\Headwall.dwg

SHEET 1 OF 1 SCALE: NO SCALE

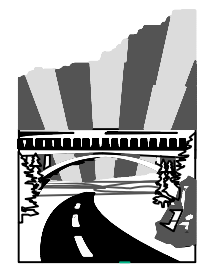

**JACKSON COUNTY**  
*Roads*