

BARBED WIRE: 4 POINT, 12 1/2 GAUGE.

## TYPE A FENCE

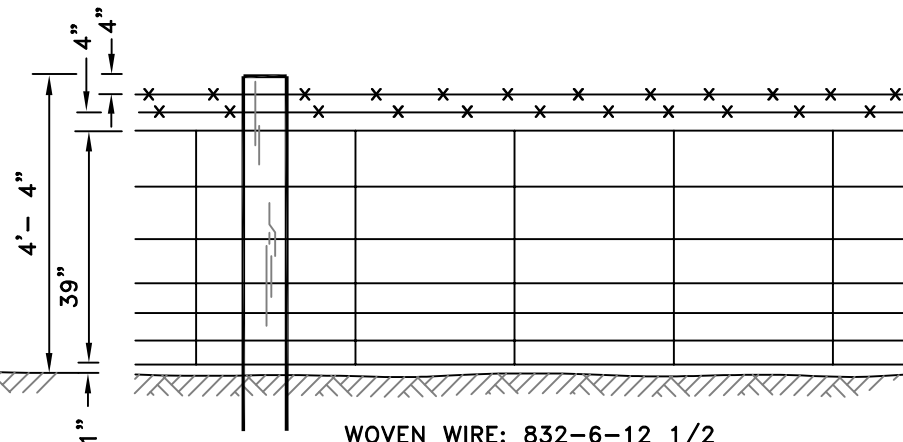

## TYPE B FENCE

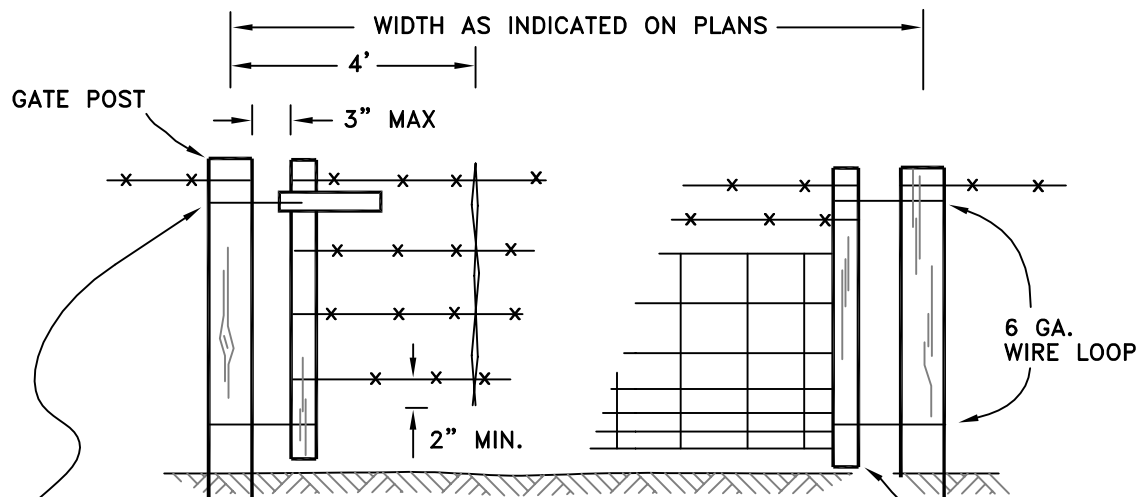

1/4" SHORT LINK COIL CHAIN,  
BOLTED TO GATE POST APPROX.  
5" FROM END OF LOCKING BAR.

## GATEWAY

END BAR, 4'-4" LONG  
TYPE 1 OR 2 POST MATERIAL.

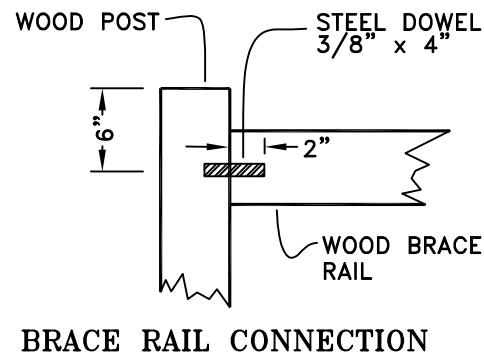

JACKSON COUNTY ROADS

DALE W. PETRASEK, P.E.  
COUNTY ENGINEER

Date	By	Revision
1/2002	TMJ	

FENCES

I:\Engineering\Library\County\English\Fences.dwg

SHEET 1 OF 1 SCALE: NO SCALE



JACKSON  
COUNTY  
Roads