

# VOTING INSTRUCTIONS

USE A PENCIL ONLY

At the Primary Election of 2004 the voters of Jackson County will cast their votes on the ballot illustrated below. This page has been inserted into the Voters' Pamphlet as an aid for using this ballot.

- 1. TO ENSURE YOUR VOTE COUNTS, COMPLETELY FILL IN THE OVAL (●) TO THE LEFT OF THE RESPONSE OF YOUR CHOICE.**
- 2. TO WRITE IN A NAME — COMPLETELY FILL IN THE OVAL (●) TO THE LEFT OF THE DOTTED LINE AND WRITE THAT NAME ON THE DOTTED LINE.**

## EXAMPLE

### PRESIDENT (VOTE FOR ONE)

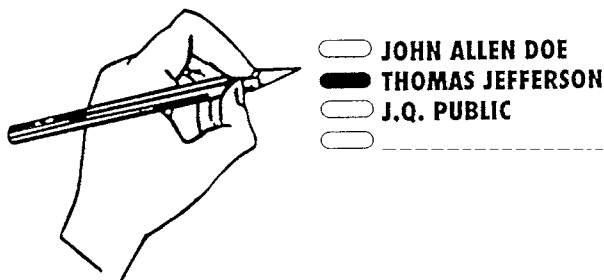

- 3. DO NOT CROSS OUT — IF YOU CHANGE YOUR MIND, CONTACT THE ELECTIONS DEPARTMENT AT 774-6148 FOR A REPLACEMENT BALLOT.**

**REMEMBER, IF STATED ON YOUR BALLOT,  
VOTE BOTH SIDES OF YOUR BALLOT!**

## check your ballot!

Make sure you have completely filled in the ovals next to your choices.

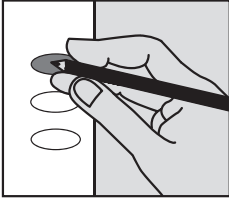

If you vote for more candidates than allowed, or if you vote **both** Yes **and** No on a measure, it is called an overvote.

Your vote **will not count** for that candidate or measure.

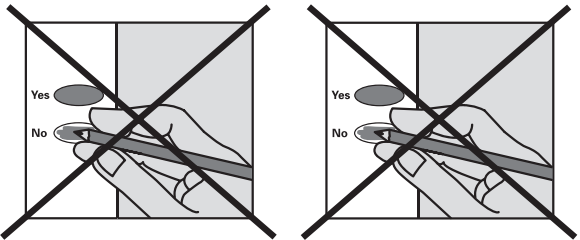

You do not have to vote on all contests. Those you do vote on will still count.

Contact Jackson County Elections to request a replacement ballot if:

- you make a mistake
- your ballot is damaged or spoiled
- your ballot is lost

or for any other reason.

---

### **Jackson County Elections**

1101 W Main Street Suite 201  
Medford OR 97501

541 774 6148

[www.co.jackson.or.us](http://www.co.jackson.or.us)