



# Jackson County Voters' Pamphlet

## SPECIAL ELECTION November 6, 2007

### ASHLAND SCHOOL DISTRICT NO. 5

### Measure No. 15-80

#### BALLOT TITLE

#### **15-80 ASHLAND SCHOOL DISTRICT THREE YEAR LOCAL OPTION OPERATING LEVY**

**QUESTION:** Shall Ashland School District levy a local option tax of \$1.29 per thousand of assessed value beginning July 1, 2008? This measure may cause property taxes to increase more than three percent.

**SUMMARY:** This measure may be passed only at an election with at least 50% voter turnout. Inspiring students to be lifelong learners, responsible citizens and stewards of the world: this is the core mission of the Ashland School District. The Youth Activities Levy (YAL), which has helped support the District's mission since 1994, will expire June 30, 2008. All students attending Ashland Public Schools have benefited from the Youth Activities Levy and the District is asking voters to replace this funding. Recent rulings of the Oregon Supreme Court have encouraged the Ashland School District to reconfigure the YAL into the Youth Activities and Academics Levy (YAAL). The YAAL will provide revenue for student athletics, arts and activities, as well as enhanced academic programs and classes. Because the YAAL will raise revenue from the entire School District, rather than just the city of Ashland, the rate of the YAAL will be lower than that of the YAL.

A rate of \$1.29 per thousand of assessed value is estimated to raise \$3,283,899 for 2008-09, \$3,415,255 for 2009-2010, and \$3,551,865 for 2010-11, for a total of \$10,251,019 over three years. The estimated tax cost for this measure is an ESTIMATE ONLY based on the best information available from the county assessor at the time of the estimate.

#### EXPLANATORY STATEMENT

The Youth Activities Levy (YAL), a local option tax levied by the city of Ashland, was first approved by the voters in 1994 in response to the impact of Measure 5 on the Ashland School District. Since then, it has been renewed three consecutive times to the present level of \$1.38 per thousand dollars of assessed property value. Recent decisions of the Oregon Tax Court and the Oregon Supreme Court have precluded a renewal of the YAL. The Ashland School District proposes to replace the YAL with the Youth Activities and Academics Levy (YAAL), which is a local option tax under the Ashland School District's taxing

authority. In 1999, the Oregon Legislature gave school districts the authority to pass a local option levy, an option that was not available to the District when the YAL was originally enacted. Additional legislation enacted in 2007 further enhanced the viability of a local option tax for the Ashland School District.

This new levy has several important changes:

- It will tax the entire school district. Since the YAL was levied by the city, only property owners within the city limits participated in the levy. The boundaries of the Ashland School District are larger than the city boundaries, so all patrons of the District can participate in the YAAL. This will eliminate the fees that have been paid by students attending Ashland schools who do not live within the city boundaries.
- Because the levy will be applied to more properties, the tax rate for property owners in Ashland will go down to \$1.29 per thousand of assessed valuation. For the owner of a home in Ashland assessed at \$250,000, the levy would cost approximately \$322.50 per year.
- The YAL expenditures were limited to extra and co-curricular activities. The new YAAL can be spent on all aspects of district programming. This will enable the Ashland School District to maintain a wide range of activities and athletics while increasing support to the academic program.

Research and our own local experience reveal that students who participate in some extra or co-curricular activity are much more likely to be successful in school. Passage of the new local option tax will enable the District to continue providing many different choices of student activities and athletics. It will also allow the District to limit further cuts to the academic program due to the loss of revenue from declining enrollment.

"Ashland Schools: Empowering students to be lifelong learners, responsible citizens and stewards of the world" is the recently adopted vision statement of the District. Passage of the YAAL will help the District to continue to challenge students to be creative and critical thinkers and to set the foundation for a life-long learning process based on motivation, inspiration and opportunity. The passage of the Youth Activities and Academics Levy will give Ashland School District additional resources towards the goal of maintaining the District's high standards and level of student success.

*(Information furnished by Julianne M. Di Chiro, Ashland School District No. 5.)*

ASHLAND SCHOOL DISTRICT NO. 5

Measure No. 15-80

ARGUMENT IN FAVOR

Vote YES on the Youth Activities & Academics Levy

"Girls who play interscholastic high school sports are 41 percent more likely to graduate from college than their counterparts." This is the results of a study done on the 25th anniversary of Title IX, in June's issue of Youth & Society. The study concluded that the athletes had the advantage of "social capital", a network invested in their success, mentor coaches and all those parents in the stands sharing college information.

I believe that this holds true for all students. Athletics, Music, Art, Drama, etc. create the "social capital" necessary to nurture children into happy, confident, and successful contributors to our community.

Athletics, Music, Art, Drama, etc. are no longer supported by state educational funding levels; especially in small communities like Ashland with fewer students in which to spread fixed educational cost burdens.

Since 1997, Ashland has supported our youth through a local Youth Activity Levy. It has kept athletics, music, art, drama, foreign language study and other programs available to our children. Renewing this Levy allows Ashland Schools to continue these programs and with this renewal, also cover shortfalls occurring in core curriculums due to limited state funding.

I urge you to vote "Yes" and renew the Levy for 3 more years. This is not a tax, but a continued investment into the children of our community and the quality of everyone's future.

(Information furnished by Carol Horn Davis.)

ARGUMENT IN FAVOR

PURPOSE

The current YAL (Youth Activities Levy) will be expiring soon. This measure replaces the YAL with the YAAL (Youth Activities & Academics Levy)

KEY FACTS

- Collection authority changes
  - o YAL was levied by City of Ashland
  - o YAAL will be levied by Ashland School District
- Collection boundaries change
  - o YAL collected from City of Ashland
  - o YAAL collected from entire Ashland School District
- Levy rate declines
  - o YAL is now \$1.38/\$1000
  - o YAAL will be \$1.29/\$1000
- Continues to provide critical funds
- Removes limitations
  - o YAL could not be used for core curriculum
  - o YAAL can be used for extra-curricular, co-curricular, and core curricular purposes
- No overlap
  - o YAL expires June 2008
  - o YAAL starts July 2008
- 3 year term
  - o YAAL expires June 2011

REASONS TO VOTE YES

- **Necessary.** The YAL served us well for many years. Recent court decisions require us to use a different approach.
- **Fair.** District properties outside the City of Ashland benefited from the retiring YAL. The new YAAL distributes payment responsibility across all properties that benefit. The new YAAL also eliminates pay-to-play fees for students outside the city limits but within the district.
- **Responsible.** Sharing the load across the entire school district decreases the payment burden on each current YAL payer while continuing to provide the critical funds necessary to maintain Ashland School District educational quality.
- **Flexible.** YAL revenues have fully funded extra and co-curricular activities while state funding decreases have made core academics difficult to fully fund. As enrollment declines fully funding core academics will become still more difficult. YAAL allows district staff, the board, and the citizen budget committee to balance core, extra, and co-curricular funding every year.

(Information furnished by Richard Barth, Ashland Youth Activities & Academics Committee.)

The printing of these arguments does not constitute an endorsement by the County of Jackson, nor does the county warrant the accuracy or truth of any statement made in the arguments.

The printing of these arguments does not constitute an endorsement by the County of Jackson, nor does the county warrant the accuracy or truth of any statement made in the arguments.

ASHLAND SCHOOL DISTRICT NO. 5

**Measure No. 15-80**

**ARGUMENT IN FAVOR**

How do Ashland students benefit from the Youth Activities & Academics Levy?

They experience. They learn. They grow.

Through our financial support, we give our children the opportunity to seek and find their lifelong passions. The levy provides students the means to discover who they are and what they are capable of accomplishing.

They experience the thrill of playing on a championship team, the pain of losing a close match, the joy of nailing an individual performance, and the excitement of watching friends and peers giving their “all” during their time to perform, and perhaps most importantly, that the journey can be more important than the destination.

They learn to lead and to follow. To participate and to observe. To listen and to communicate. To work with others. To show compassion. To understand honor. They learn necessary life skills that classrooms alone cannot provide.

The expiring YAL, and the replacement YAAL, allow our children to develop in the ways we want them to learn and grow - through creative, competitive, artistic, academic, challenging endeavors supervised by caring, professional adults.

Please vote “Yes” on Measure 15-80.

**Supported by the past YAL:**

- |                           |  |
|---------------------------|--|
| Basketball – boys & girls | Math club                              |
| Bowling club              | Mock Trials                            |
| Cheerleaders/rally        | Model UN                               |
| Crew club                 | Elementary Strings                     |
| Cross country             | National Honor Society                 |
| Dance                     | Tennis – boys and girls                |
| Equestrian club           | Intramural softball                    |
| Football                  | Intramural basketball                  |
| Golf – boys and girls     | Elementary PE & after-school athletics |
| Hockey club               |  |
| Nordic ski club           | Playground Assistance                  |
| Rugby club                | Second language                        |
| Outrigger canoe club      | Athletics at AMS                       |
| Ski club                  | Resident Outdoor School                |
| Soccer – boys & girls     | Elementary Music                       |
| Pep band                  | AHS Newspaper Rogue News               |
| Track – boys & girls      | Be a Fit Kid                           |
| VICA                      | Marimba club                           |
| Intramural volleyball     | Child Development Specialists          |
| Club transportation       | Leadership                             |
| OSAA Tournament travel    | Science Bowl                           |
| Brain Bowl                | Scavenger Hunt                         |
| Debate                    | Choir                                  |
| Drama                     | Aspire College Counselors              |
| DECA                      | Swimming – boys & girls                |
| Fresh Start               | Intramural track                       |
| International club        | Volleyball                             |
| Wrestling                 | Water polo club                        |
| International club        | Snowboard club                         |

*(Information furnished by Amy Amrhein,  
Ashland Youth Activities and Academics Levy Committee.)*

**ARGUMENT AGAINST**

**NONE FILED**

The printing of these arguments does not constitute an endorsement by the County of Jackson, nor does the county warrant the accuracy or truth of any statement made in the arguments.

# VOTING INSTRUCTIONS

## YOU MAY USE A PENCIL OR PEN

At the Special Election of 2007 the voters of Jackson County will cast their votes on the ballot illustrated below. This page has been inserted into the Voters' Pamphlet as an aid for using this ballot.

1. **TO ENSURE YOUR VOTE COUNTS, COMPLETELY FILL IN THE OVAL (●) TO THE LEFT OF THE RESPONSE OF YOUR CHOICE.**

### EXAMPLE

#### PRESIDENT (VOTE FOR ONE)

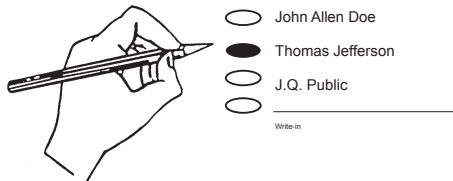

2. **DO NOT CROSS OUT — IF YOU CHANGE YOUR MIND, CONTACT THE ELECTIONS DEPARTMENT AT 774-6148 FOR A REPLACEMENT BALLOT.**

**REMEMBER, IF STATED ON YOUR BALLOT, VOTE BOTH SIDES OF YOUR BALLOT!**

### check your ballot!

Make sure you have completely filled in the ovals next to your choices.

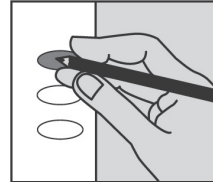

If you vote for more candidates than allowed, or if you vote **both Yes and No** on a measure, it is called an overvote.

Your vote **will not count** for that candidate or measure.

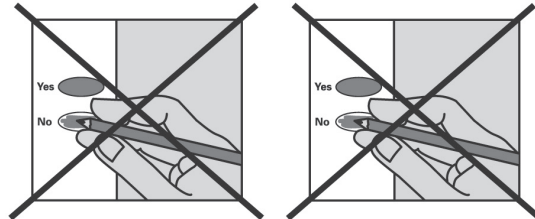

You do not have to vote on all contests. Those you do vote on will still count.

Contact Jackson County Elections to request a replacement ballot if:

- you make a mistake
- your ballot is damaged or spoiled
- your ballot is lost

or for any other reason.

#### Jackson County Elections

1101 W Main Street Suite 201  
Medford OR 97501

541 774 6148

[www.co.jackson.or.us](http://www.co.jackson.or.us)